

Site Accommodation

www.atcosl.com.au



Site Offices | Complexes | Lunchrooms | Toilets | Ablutions | Change Rooms | First Aid Rooms

ATCO Structures & Logistics



Contents

Business Profile	2
Offices	3
Lunchrooms	5
Change Rooms / First Aid	5
Toilets	6
Locations	7

ATCO

ATCO

1800 70 70 77
www.atco-structures.com

Business Profile

ATCO Structures & Logistics (ATCO) is recognised as one of Australia's leading modular building providers.

With a history that dates back to 1947, **ATCO** has a reputation of delivering modular solutions and associated site services on time and on budget. **ATCO** has been associated with numerous projects that have been milestones in shaping Australia's industrial history. **ATCO** has developed into an internationally recognised brand that has operations within North America, South America, Middle East, Asia and Europe.

ATCO has a primary focus within Australia and has developed a network of offices and infrastructure in Townsville, Mackay, Gladstone, Brisbane, Newcastle, Sydney, Melbourne and Perth to meet the ever changing construction and mining industry landscapes presented.

Having built one of Australia's largest rental fleets of modular buildings, **ATCO** are capable of mobilising project needs quickly. **ATCO**'s strength lies in their experience and ability to deliver when it counts. **ATCO** prides itself on providing Australian made products that are built to stand up to the demands of the rigorous environments encountered in remote Australia.

Defining our business through superior service, **ATCO** has retained and developed its workforce who are focused on delivering a multitude of project disciplines, whilst maintaining the core business ethics of professionalism and transparency.

ATCO has a diverse customer base and has expertise in delivering products to the construction, mining, education, oil and gas and commercial industries, with the ability to customise building design to suit a specific project requirement. **ATCO** has the expertise and capacity to deliver a rapid, full turnkey solution anywhere, anytime it is needed.

"Their adherence to safe processes and site requirements, combined with brilliant work ethics and pride in workmanship is a rare thing to find. I have no hesitation in recommending ATCO to anyone who requires this service."

Shell Refining (Australia) Pty Ltd



Offices

3.0m x 3.0m Office
OF 100

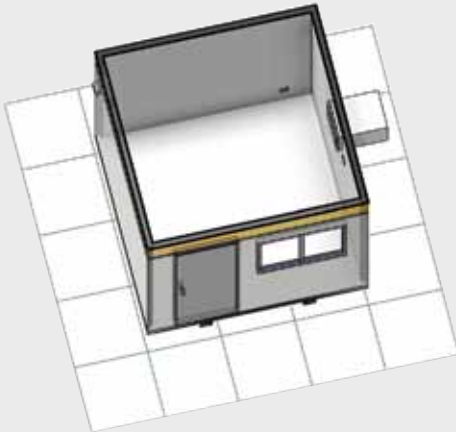

3.6m x 3.0m Office
OF 110

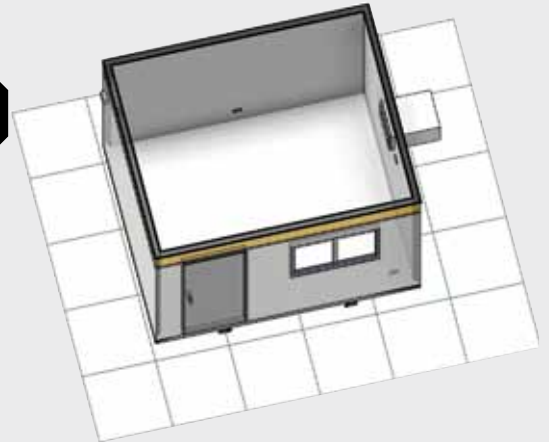

4.8m x 2.4m Office
OF 115

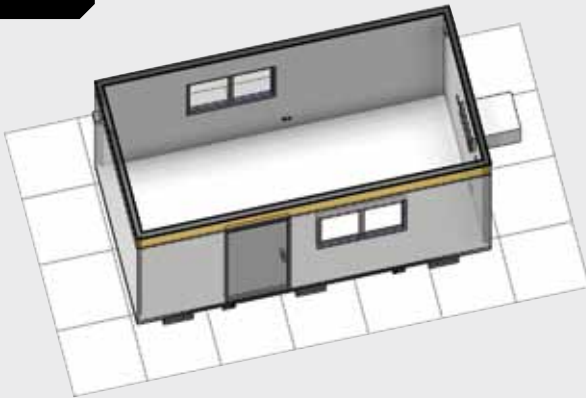

6.0m x 3.0m Office
OF 130

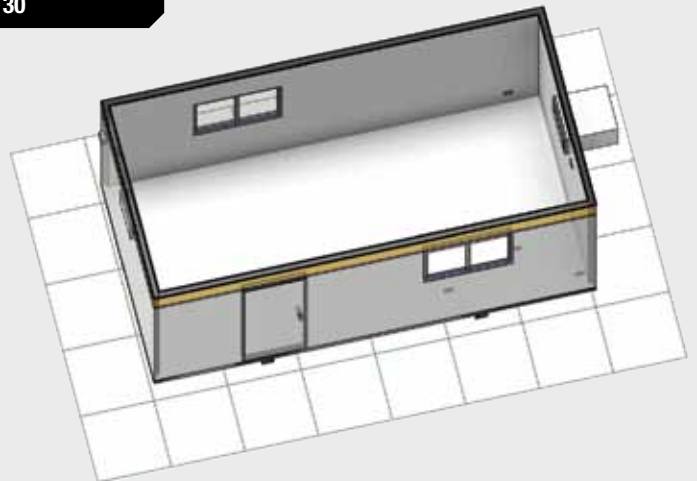

7.2m x 3.0m Office
OF 140

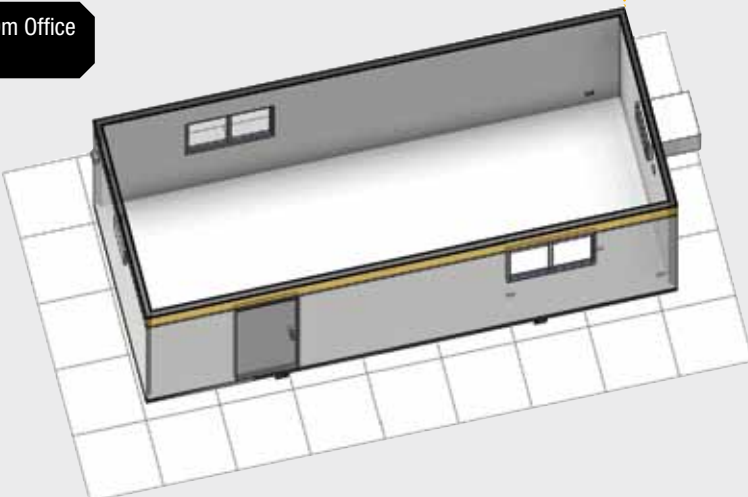

12.0m x 3.0m Office
OF 190

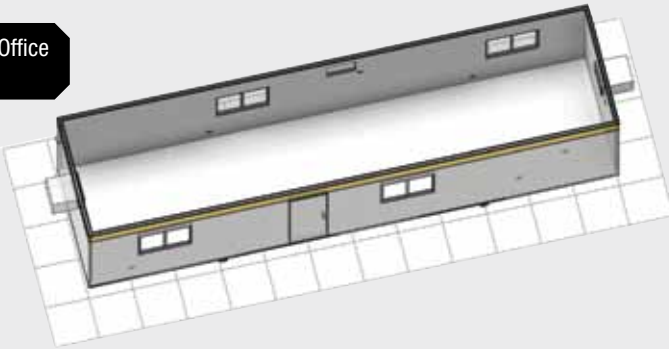

12.0m x 3.0m Office
OF 191

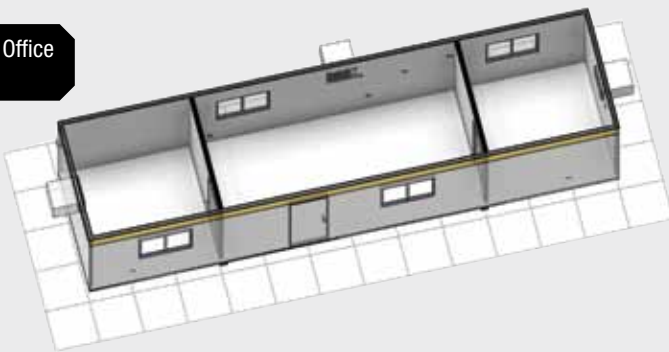

12.0m x 6.0m Office
OF 510

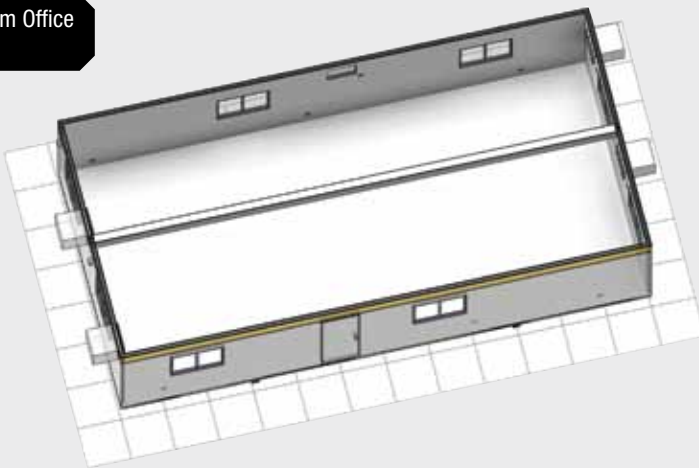

12.0m x 9.0m Office
OF 525



12.0m x 9.0m Office
OF 520

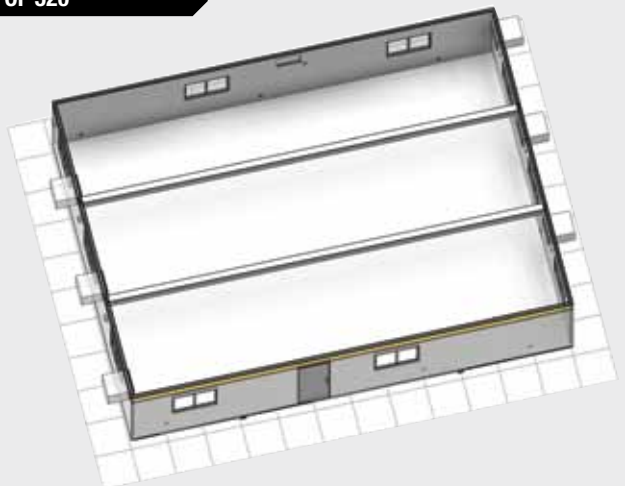

"I have been associated and dealing with ATCO Representatives from the start of 2003 up to the present day and within my relationship with ATCO staff we have achieved many projects such as installations of classrooms, sourcing office solutions and relocating buildings. These works have been carried out to an excellent standard and efficiently always finishing the tasks on time. I have no hesitation in recommending ATCO Structures Staff and the work they do to any prospective company wishing to contract them." Westside Christian College

Lunchrooms

4.8m x 2.4m Lunchroom
LR 010



4.8m x 3m Lunchroom
LR 012

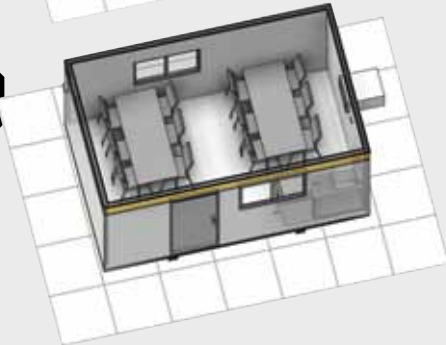

6.0m x 3.0m Lunchroom
LR 018

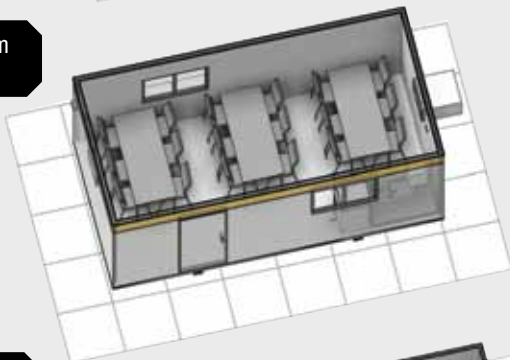

12.0m x 3.0m Lunchroom
LR 036



Change Rooms / First Aid

6.0m x 3.0m Change Room
CH 020

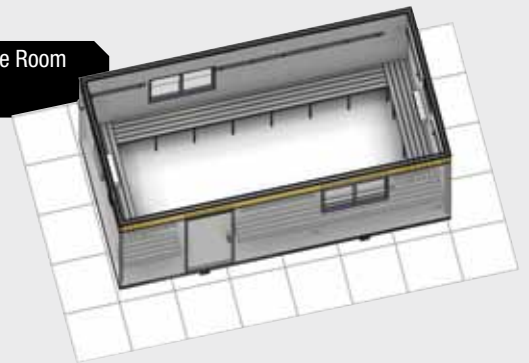

6.0m x 3.0m First Aid
FA 025

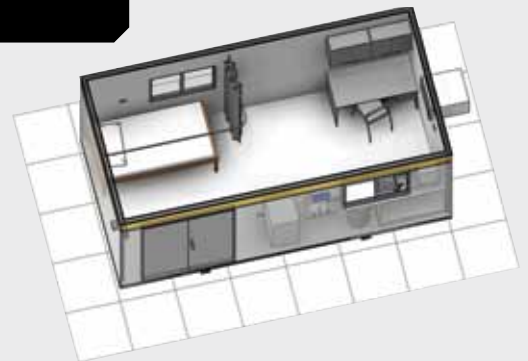

12.0m x 3.0m Change Room
CH 030



Toilets

2.4m x 2.4m Male/
Female Toilet **MFT 010**

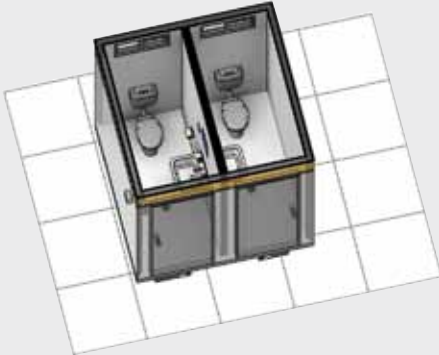

3.0m x 3.0m Toilet
WC 015



3.6m x 3.0m Toilet
WC 020

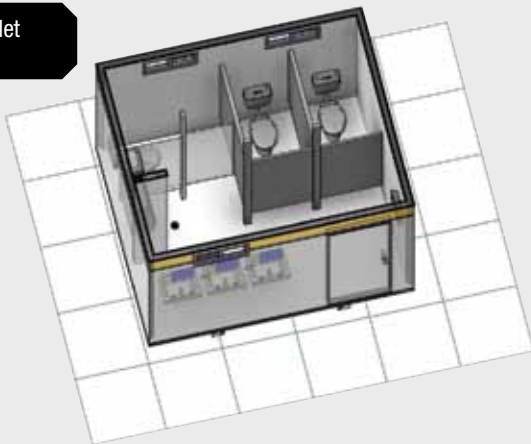

4.8m x 3.0m Male/
Female Toilet **MFT 015**

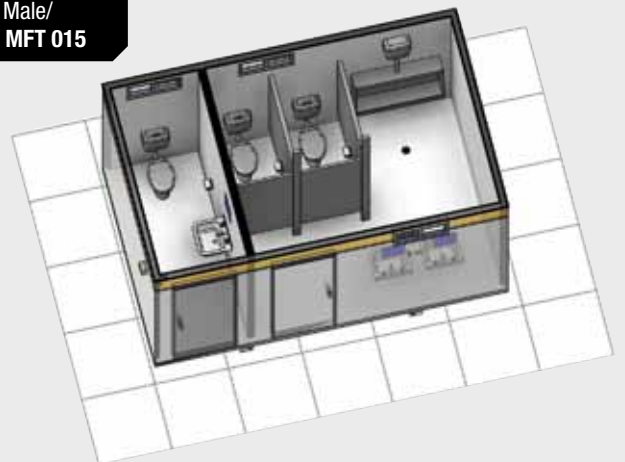

6.0m x 3.0m Ablution
AB 040

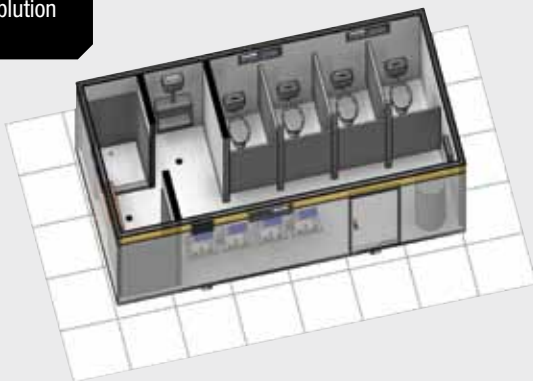

4.8m x 3.0m Ablution
AB 035

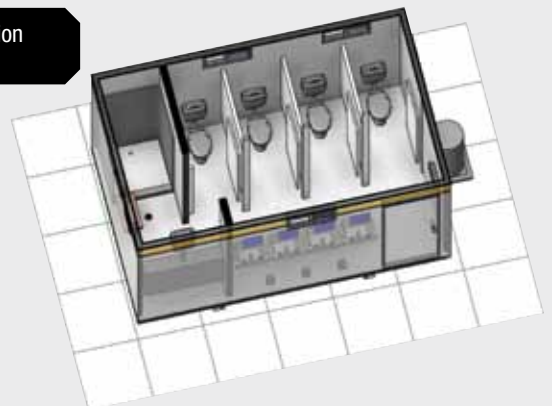

6.0m x 2.4m Tank

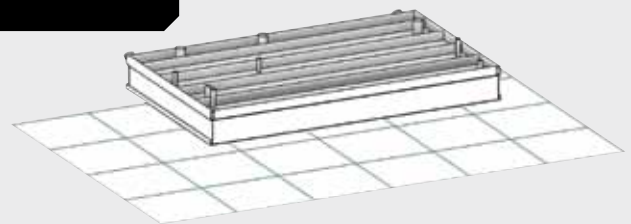

"ATCO were able to meet an extremely tight timeframe imposed by Melbourne Water for the delivery of the project offices and have positively responded to any requests by Melbourne Water to attend to site for minor issues. The site accommodation has been well received and the project was completed in a safe and efficient manner. I have no hesitation in recommending ATCO for any large or small project you may be considering them for." Melbourne Water

Locations

QUEENSLAND

Brisbane

(Australia Head Office)

ATCO Structures & Logistics Pty Ltd

55 Tonka Street

Luscombe QLD 4207

Phone: (61) 7 3412 8600

Fax: (61) 7 3412 8699

Brisbane Sales

ATCO Structures & Logistics Pty Ltd

55 Tonka Street

Luscombe QLD 4207

Phone: (61) 7 3050 5800

Fax: (61) 7 3050 5899

Townsville

ATCO Structures & Logistics Pty Ltd

826 Ingham Road

Bohle QLD 4818

Phone: (61) 7 4774 6633

Fax: (61) 7 4774 6440

Mackay

ATCO Structures & Logistics Pty Ltd

Walker Complex, Harbour Road

Mackay QLD 4740

Phone: (61) 7 4829 3800

Fax: (61) 7 4942 4469

NEW SOUTH WALES

Newcastle

ATCO Structures & Logistics Pty Ltd

2376 Pacific Highway

Heatherbrae NSW 2324

Phone: (61) 2 4008 5600

Fax: (61) 2 4008 5699

Sydney

ATCO Structures & Logistics Pty Ltd

47 Mulgrave Road

Mulgrave NSW 2756

Phone: (61) 2 4545 2900

Fax: (61) 2 4577 7372

VICTORIA

Melbourne

ATCO Structures & Logistics Pty Ltd

128 Hallam Valley Rd

Dandenong South VIC 3175

Phone: (61) 3 8765 8200

Fax: (61) 3 9791 9271

WESTERN AUSTRALIA

Perth

ATCO Structures & Logistics Pty Ltd

28 Armstrong Road

Hope Valley WA 6165

Phone: (61) 8 6252 6200

Fax: (61) 8 6252 6299



ATCO Structures & Logistics

For further information

Telephone – (61) 7 3412 8600

Facsimile – (61) 7 3412 8699

www.atcosl.com.au

